

Varenummer: 252000300417
 Beskrivelse: ICME IE2 asynkronmotor THE 100L B4
 3kW 1440 o/min 230/400 B35

Mål

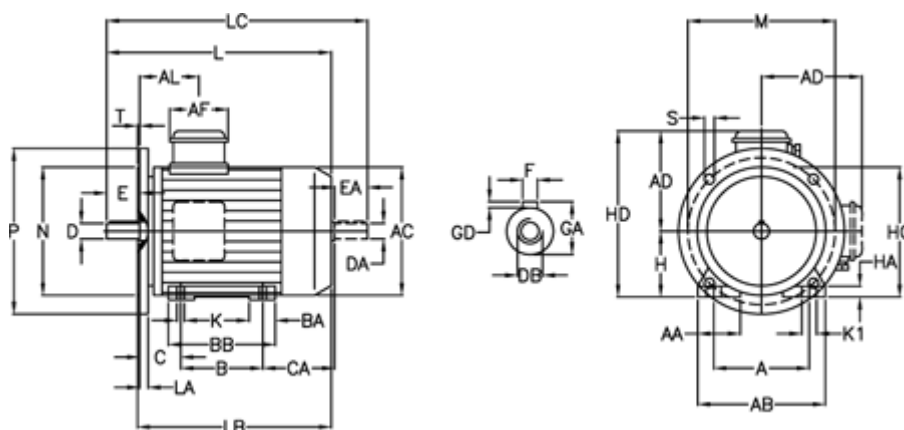

A = 160	BA = 40	EA = 60	K = 12	P = 250
A/F = 84	BB H7 = 176	F = 8	K1 = 20	S = 14
AA = 42	C = 63	GA = 31	L = 366	T = 4
AB = 200	CA = 105	GD = 7	LA = 14	
AC = 195	D = 28	H = 100	LB = 306	
AD = 140	DA = 28	HA = 14	LC = 429	
AL = 96	DB = M10	HC = 200	M = 215	
B = 140	E = 60	HD = 240	N = 180	